

Handling System for Rack Type Manual Sorting Table, 5 Baskets - Right to Left, 2640mm - Side Connection

ITEM # _____

MODEL # _____

NAME # _____

SIS # _____

AIA # _____

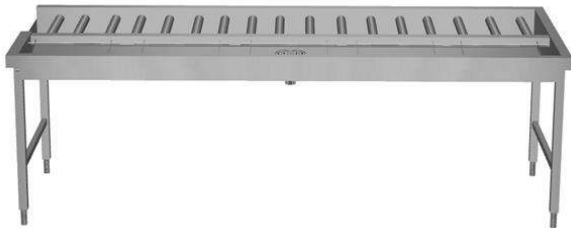
865259 (HSMSS5RL)

 Manual sorting table, 5
baskets, side connection,
Right>Left, 2640 mm

Short Form Specification

Item No.

Constructed in 304 AISI stainless steel. Basin with sloping bottom, drain with double strainer baskets. Long plastic rollers. Rack-guides inclined towards the sorting side. Square 40x40mm square legs with height-adjustable feet. Designed for 500x500mm dishwashing baskets. Attachment to Rack Type dishwasher or other tables on the left side. Basket feed direction: from right to left.

Main Features

- Designed to transport 500x500 mm dishwashing baskets.
- "Key holes" and "snap on" system reduces the number of screws needed for fast and easy installation.
- Long rollers and strainer box easy to remove.
- Manual racks handling toward the dishwasher made easier thanks to the long rollers.
- Manual sorting table with side loading can be connected either to a rack type dishwasher or after the roller conveyor, a 90° dishwasher driven curve and a side loader on the loading side.

Construction

- All surfaces smooth with polished finish.
- Constructed in AISI 304 stainless steel with square 40x40mm legs.
- Thick welded flanges for sturdy connection between the units.
- Sloping bottom of the table grants a smooth and rapid drainage.
- Stainless steel strainer baskets easy to remove.
- Connection from side.
- Manual receiving and sorting operations.
- Optionally equipped with tray slides, a single adjustable over-shelf for empty baskets, a double adjustable over-shelf for sorting of baskets and empty baskets, spray guns, cutlery soaking basin and basin wash nozzles.
- Stainless steel feet 50 mm adjustable in height to align the operation height between the dishwasher and table.

Optional Accessories

- Pre-rinse unit (thermostatic mixer and shower) to be mounted on overshelf PNC 863136
- Emergency stop kit for Rack Type Dishwasher (not for Basic handling system) PNC 865162
- Basket support for vertical stacking of baskets (to be used with overshelf) PNC 865208
- Pre-rinse unit (mixer and shower) PNC 865209
- Double overshelf for 5-basket sorting table, 2630 mm PNC 865427
- Overshelf for 5-basket sorting table, 2630 mm PNC 865431
- Tray slide for 5-basket sorting table, 2640 mm PNC 865435
- Tray slide fixing brackets (3pcs) PNC 865437
- Grid undershelf for 5-basket sorting table PNC 865440
- Soaking basin with lifting device for cutlery rack PNC 865442
- Pre-wash spray unit, 1500 mm PNC 865443
- Tray slide for sorting table, 500 mm PNC 865444

APPROVAL: _____



- Tray slide with waste hole and rubber ring, 500 mm PNC 865445
- Dish scraper PNC 865447
- Water heating kit for wash basin PNC 865449
- Foldable tray slide for 5-basket sorting table, 2640 mm PNC 865456
- Retractable pre-rinse unit with fixed thermostatic water mixer, hose length, 14mm PNC 865460
- Brackets to support baskets under the sorting table PNC 865478

Front

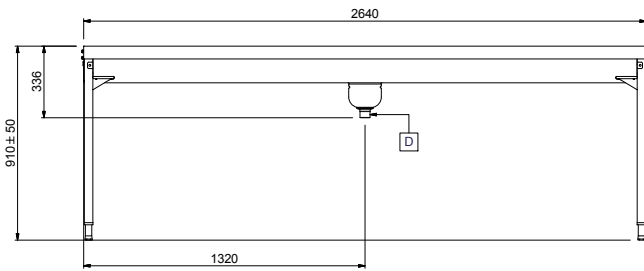

Side

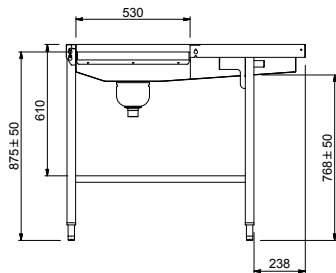

D = Drain

Top

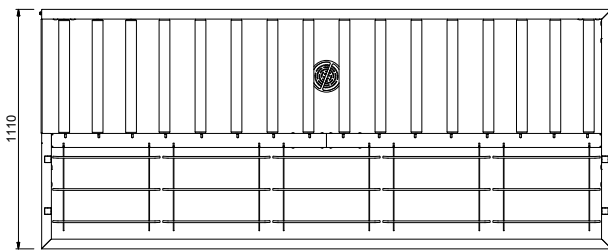

Key Information:

External dimensions, Width:	865259 (HSMSS5RL)	2640 mm
External dimensions, Depth:		1110 mm
External dimensions, Height:		910 mm
Net weight:		64 kg
Height adjustment:		50/50 mm
Basket movement:		Right to left
Basin material:		Stainless Steel AISI 304 - EN 1.4301
Type of rollers:		Long